

| JP1 CONTROL INTERFACE | |
|-----------------------|--------------------------------------------------------------------------------|
| 1 | GROUND |
| 2 | POWER ON/OFF INPUT |
| 3 | FAULT, OUTPUT 0-5V, 0V = NO FAULT, 5V = FAULT |
| 4 | TACHOMETER, OUTPUT 0-5V PULSE, FREQUENCY INDICATES MOTOR SPEED, RPM = 2/5 * Hz |
| 5 | +5V OUTPUT, USED IN CONJUNCTION WITH PIN #6 FOR SPEED CONTROL |
| 6 | SPEED CONTROL, INPUT 0-5V |

| JP5 SERIAL INTERFACE | |
|----------------------|----------|
| 1 | Vcc, +5V |
| 2 | TX |
| 3 | RX |
| 4 | GND |

| JP4 SHELL TEMPERATURE | |
|-----------------------|--------------|
| 1 | INPUT/OUTPUT |
| 2 | INPUT/OUTPUT |

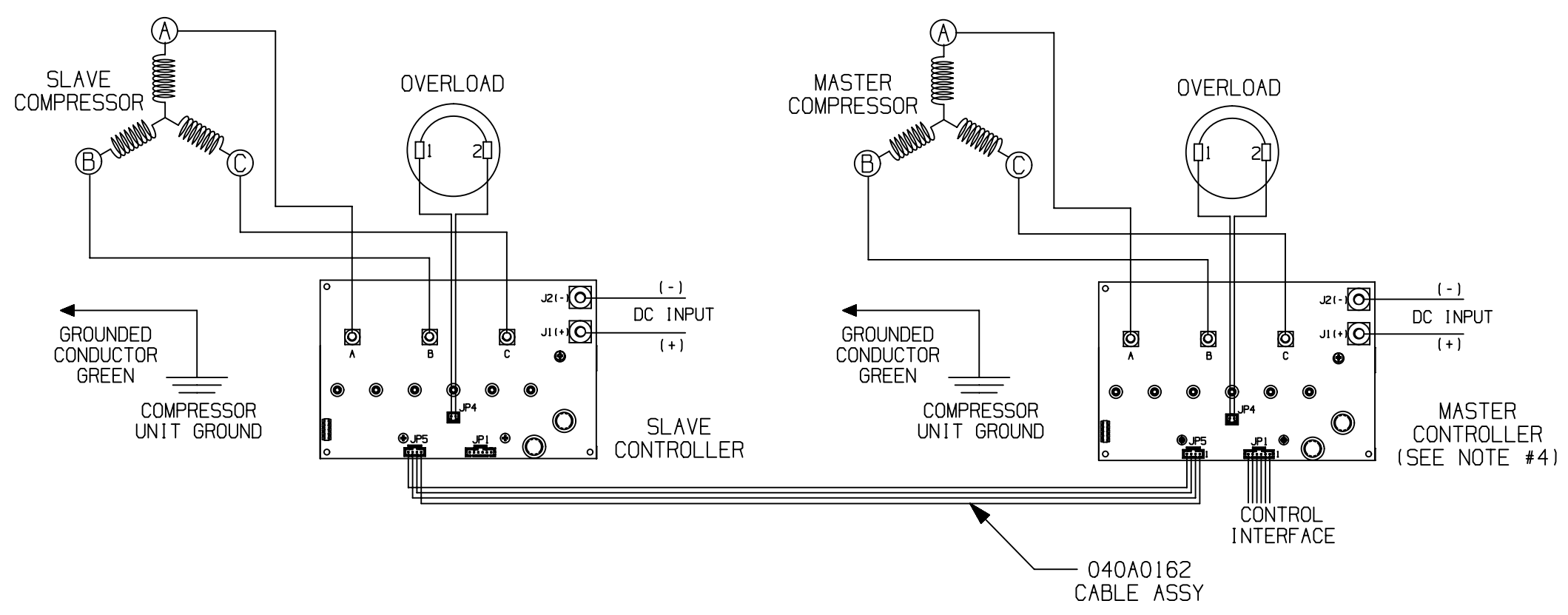
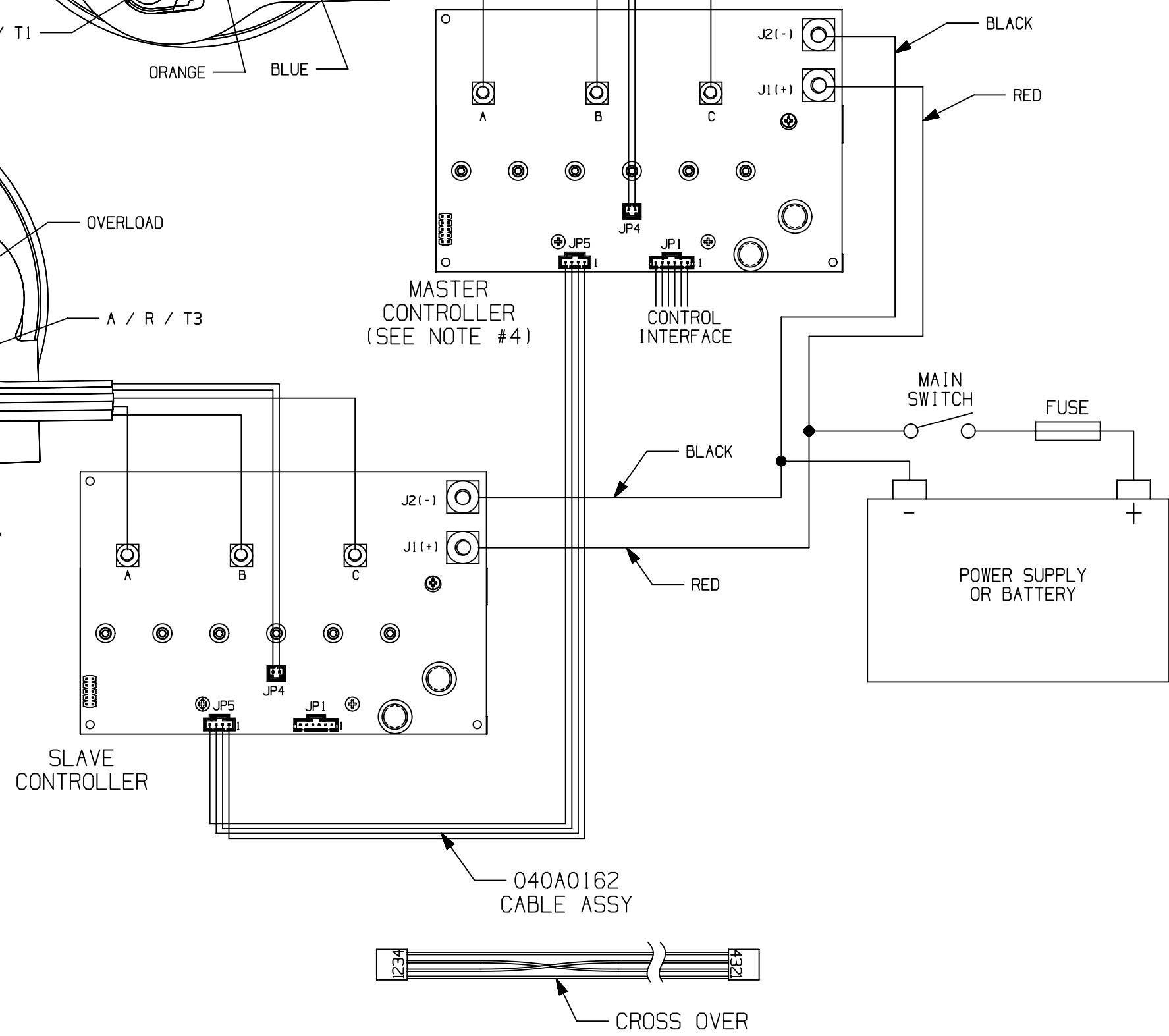
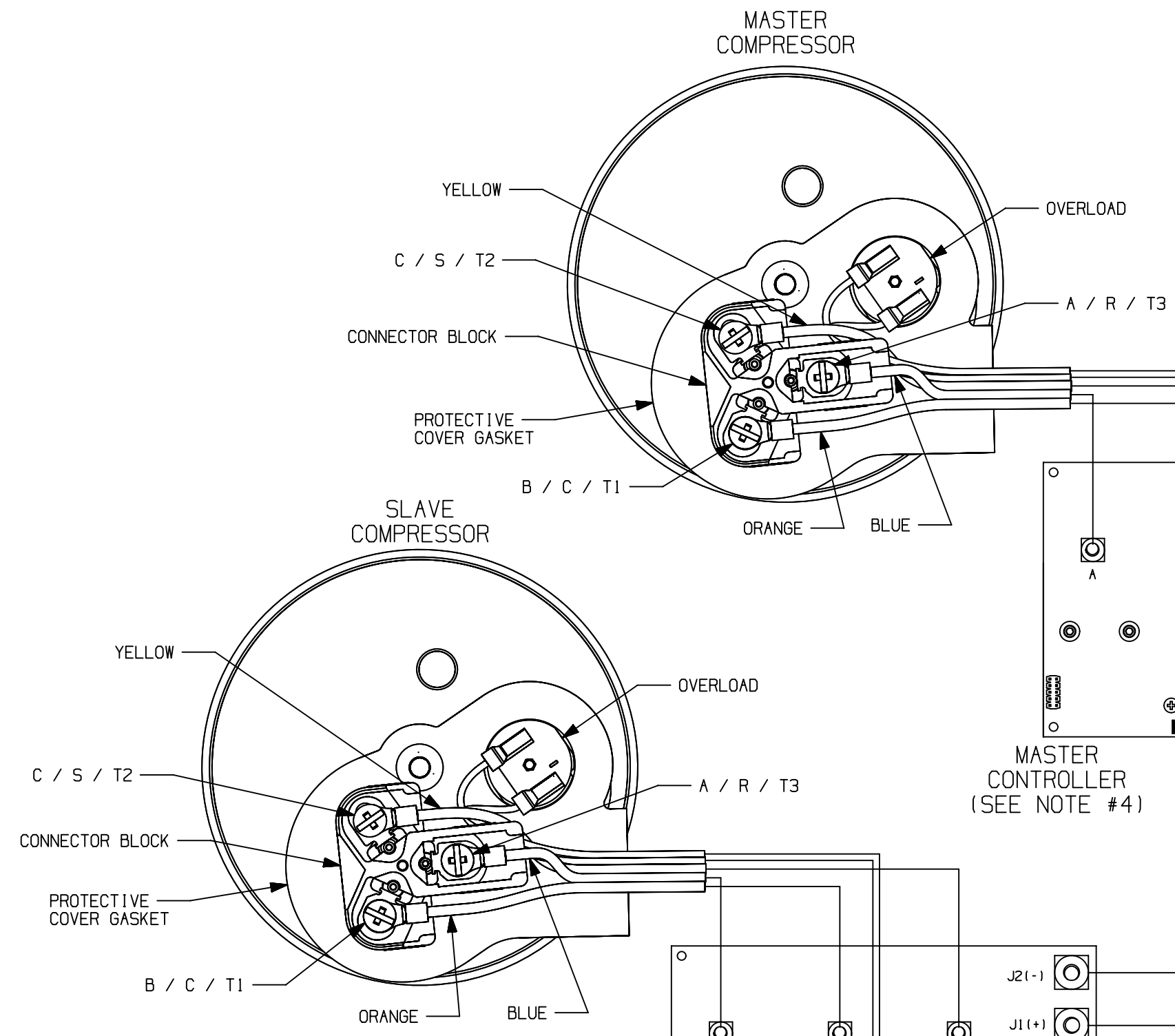
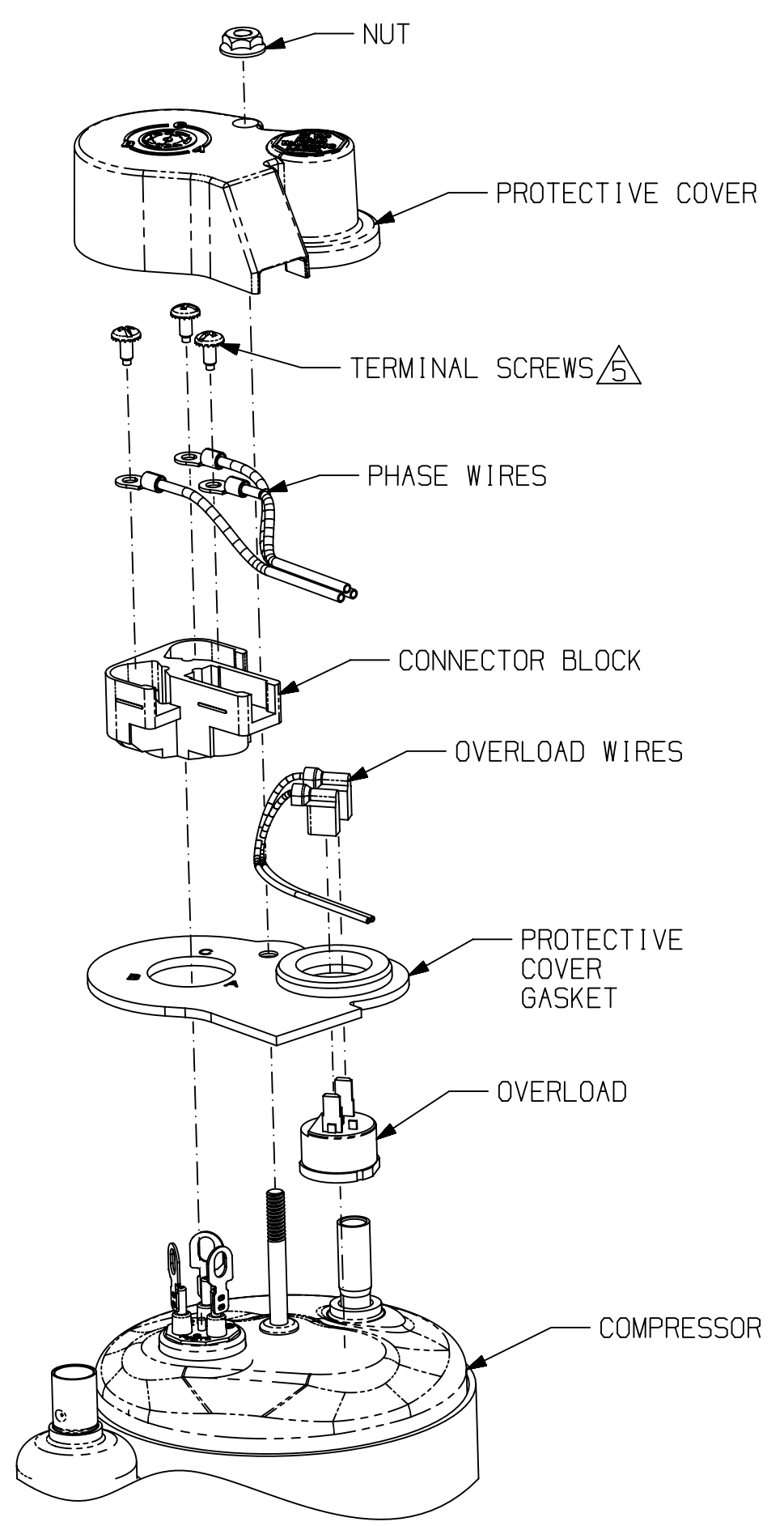

WARNING
WIRING DIAGRAM MUST BE FOLLOWED AS SHOWN. ANY MISWIRING CAN CAUSE SERIOUS ELECTRICAL HAZARD AND POTENTIAL DAMAGE OR RUPTURE OF COMPONENTS ELECTRICAL PARTS.

- NOTES:
1. ASSEMBLE PARTS AS SHOWN.
 2. COMPRESSOR GROUND HOLE LOCATED IN THE MOUNTING FEET OF THE COMPRESSOR.
 3. GROUND SCREW IS NOT PROVIDED BY MASTERFLUX.
 4. SPEED COMMAND IS ONLY CONNECTED TO THE MASTER CONTROLLER.

5. THREADED TERMINAL CONNECTIONS
- TORQUE #10-32 TERMINAL SCREWS TO 12-18 IN-LBS.
 - TORQUE M5 TERMINALS SCREWS TO 1.5-2.2 N-m
 - TERMINAL SCREWS NOT PROVIDED WITH COMPRESSOR.
6. FOR ALTERNATE WIRING CONFIGURATIONS SEE DEM0045.

ENGLISH

Q.A. SYMBOLS

- ★ = CATEGORY I
- ▲ = CATEGORY II
- = CATEGORY III
- = CATEGORY IV

| | | | | | |
|----------------------------------------------------------------------------------------------------------------------------------------------------------------------------------------------------------------------------------------------------------------------------------------------------------------------------------------------------------------------------------------------------------------------------------------------------------------------------------------------------------------------------------------------------------|-----------------|-------------|-----------------|-------------------------------------------------------|-------------|
| DIS. CODE | | DESCRIPTION | | DRAWING, SALES, ELECTRICAL, CONTROLLER, D-CLASS, DUAL | |
| RDS | 17 JUL 20 | RDS | 06 SEP 12 | DWN | RDS |
| EC79528 | UPDATED DRAWING | EC47546 | UPDATED DRAWING | ON FILE | ON FILE |
| B | .. | A | .. | SCALE | 1=1 & NOTED |
| REL | EC46770 | REL | EC46770 | THIS PRINT SUPERSEDES ALL PRINTS PRIOR TO | |
| <p>DO NOT SCALE THIS DRAWING. ALL FERROUS MATERIALS MUST BE RECEIVED AT ASSEMBLY.</p> | | | | | |
| <p>THIS DRAWING OR PRINT (L1) IS THE PROPERTY OF MESSERS. MASTERFLUX LTD. IT IS MADE AVAILABLE TO THE CUSTOMER UNDER A LICENSE. THE CUSTOMER SHALL NOT REPRODUCE OR TRANSMIT THIS INFORMATION IN ANY MANNER WITHOUT THE WRITTEN CONSENT OF MESSERS. MASTERFLUX LTD. ANY SUCH REPRODUCTION OR TRANSMISSION WITHOUT THE WRITTEN CONSENT OF MESSERS. MASTERFLUX LTD. IS STRICTLY PROHIBITED AND WILL BE DEEMED TO BE IN BREACH OF THE PATENT RIGHTS OF MESSERS. MASTERFLUX LTD. IN THE EVENT OF A DISPUTE, THE APPLICABLE LAW SHALL BE THAT OF ENGLAND.</p> | | | | <p>DWG NO. DEM0032</p> | |
| <p>DATE</p> | | | | MATERIAL | |
| <p>NOTED</p> | | | | <p>MASTERFLUX</p> | |